

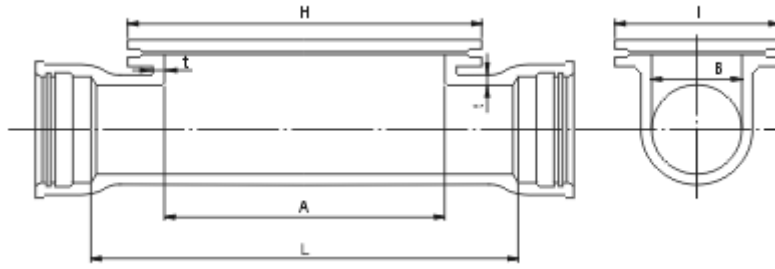

Double Socket Hatchbox



Unit : mm

DN	Thickness t	Dimensions					Weight (kg)
		L	Clear opening		Cover		
	A		B	H	I		
100	7.2	800	400	100	535	235	54.4
150	7.8	800	400	150	550	300	77.4
200	8.4	800	400	200	560	360	104.5
250	9.0	950	500	250	675	425	152.5
300	9.6	950	500	300	685	485	184.8
350	10.2	950	500	350	705	555	234.6
400	10.8	1100	600	400	820	620	306.1